

**Evans
Elder
Brown &
Seubert**

COMMERCIAL REAL ESTATE

101 E. Broadway
Suite 101
Eugene, OR 97401
(541) 345-4860

eebcre.com

FOR LEASE

322 Wallis Street, Unit B
Eugene, Oregon

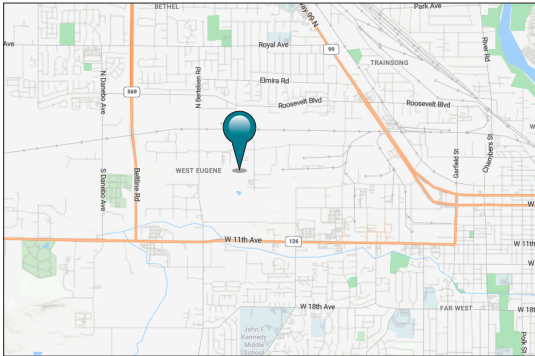

CONTACT

Stephanie Seubert
stephanie@eebcre.com

(541) 345-4860

Licensed in the State of Oregon



West Eugene Industrial Space

- Approximately 2,050 square feet of space
- Space includes one 12' x 12' roll up door, small office and restroom
- Warehouse ceiling height is approximately 14' at the base of the eaves
- The property is zoned I-2 (Light-Medium Industrial)
- 90¢ per square foot, per month, modified gross rent (tenant pays their own utilities, janitorial and \$100.00 per month toward water/sewer in addition to base rent)

The information in this package was gathered from sources deemed reliable, however Evans Elder Brown & Seubert makes no representation or warranty of the accuracy of the information. Any buyer or tenant considering a purchase or lease of this property should confirm any and all information relied upon in making the decision to purchase or lease prior to finalizing the transaction and bears the risk of all inaccuracies.

Floor Plan



322 Wallis Street, Unit B

- Approximately 2,050 square feet
- Space includes small office and private restroom with roll up door
- 90¢ per square foot, per month, modified gross. Tenant pays \$100.00 per month toward water/sewer as well as separately metered utilities

