

**Evans
Elder &
Brown** Inc.

COMMERCIAL REAL ESTATE

101 E. Broadway
Suite 101
Eugene, OR 97401
(541) 345-4860

eebcre.com

FOR LEASE

3783 International Court
Springfield, Oregon

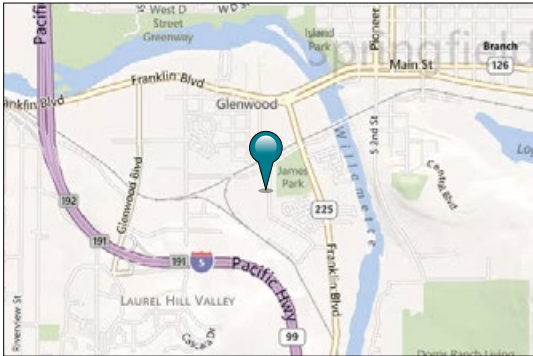

CONTACT

Alan Evans
alan@eebcre.com
(541) 345-4860

Licensed in the State of Oregon



Sports Way Business Park Phase II

- New office space, Build-to-suit
- Approximately 2,786 rentable square feet available on the first and 3,610 rentable square feet on the second floor
- Located in the heart of the Gateway District within one mile of the new River Bend Campus
- \$45.00 Tenant Improvement Allowance
- \$1.85 per square foot, fully serviced

The information in this package was gathered from sources deemed reliable, however Evans Elder & Brown makes no representation or warranty of the accuracy of the information. Any buyer or tenant considering a purchase or lease of this property should confirm any and all information relied upon in making the decision to purchase or lease prior to finalizing the transaction and bears the risk of all inaccuracies.

Aerial



Floor Plan

First Floor

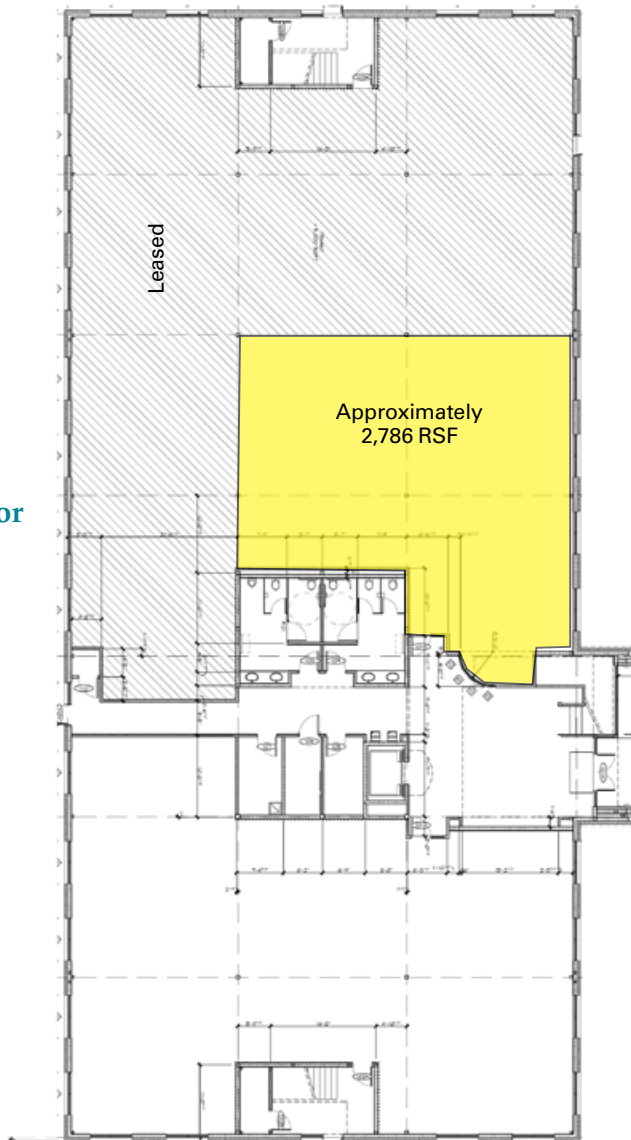

Second Floor

