

**Evans
Elder
Brown &
Seubert**

COMMERCIAL REAL ESTATE

101 E. Broadway
Suite 101
Eugene, OR 97401
(541) 345-4860

eebcre.com

FOR SUBLEASE

3783 International Court, Suite 100
Springfield, Oregon

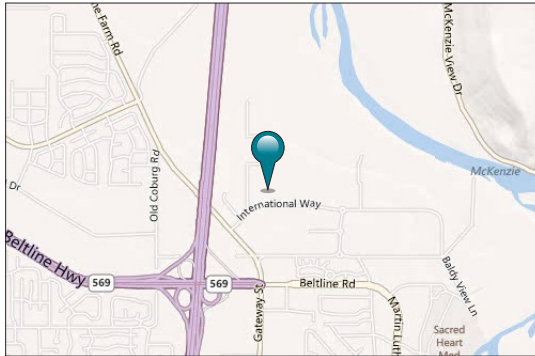

CONTACT

Stephanie Seubert
stephanie@eebcre.com

(541) 345-4860

Licensed in the State of Oregon



Sports Way Business Park

Class A space currently configured as a Physical Therapy Clinic

- Approximately 2,786 square feet of ground floor office space
- Located in the heart of the Gateway District within one mile of the River Bend Campus
- Easy access to I-5 and Randy Pape Beltline Highway
- Good on-site parking
- Master Lease runs through November 30, 2025
- \$5,580.71 per month

The information in this package was gathered from sources deemed reliable, however Evans Elder, Brown & Seubert, Inc. makes no representation or warranty of the accuracy of the information. Any buyer or tenant considering a purchase or lease of this property should confirm any and all information relied upon in making the decision to purchase or lease prior to finalizing the transaction and bears the risk of all inaccuracies.

Floor Plan

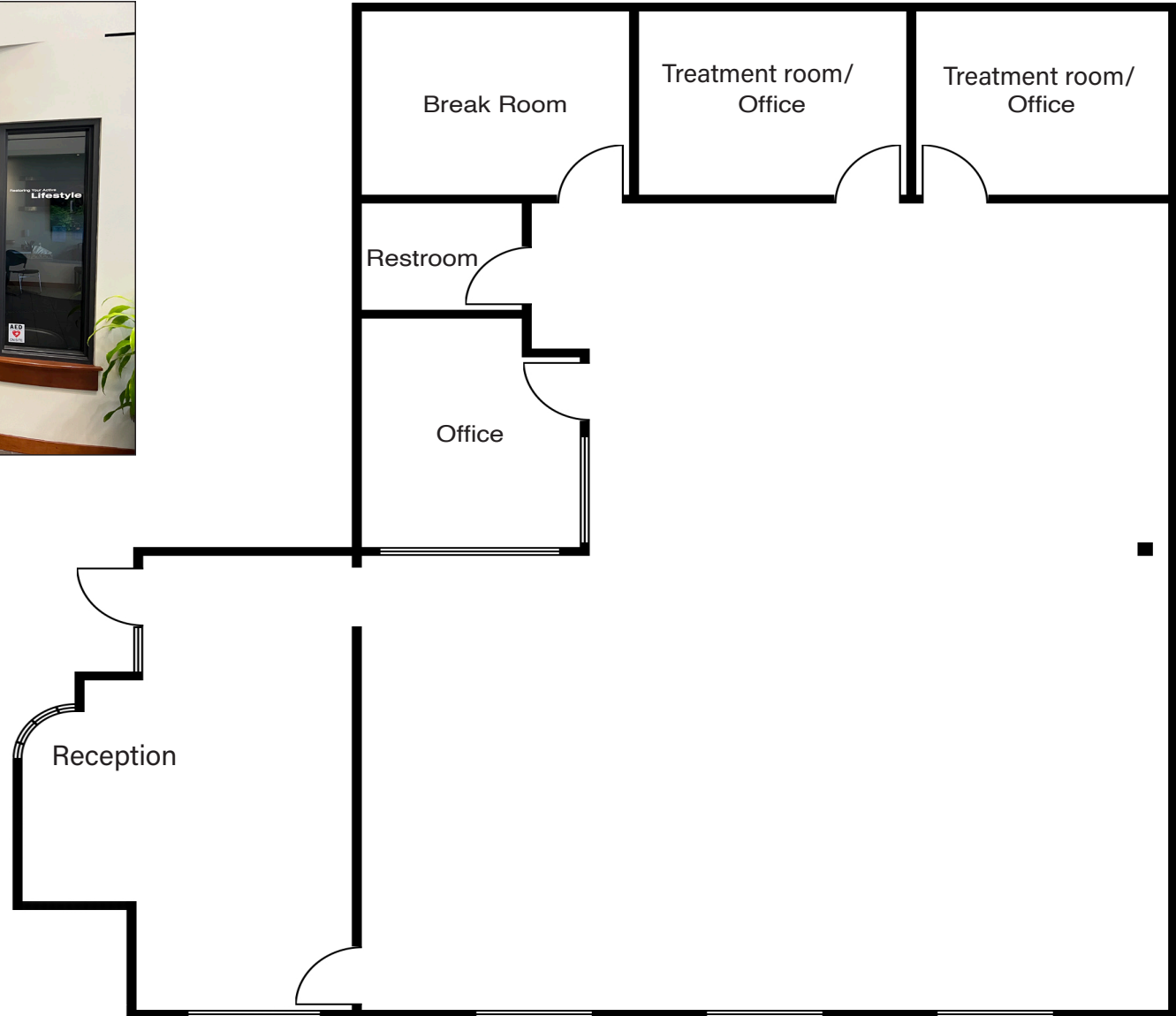

Suite 100

- Space contains reception area, two treatment rooms, charting office with built in counters/cupboards, break room, private restroom and open gym/equipment area
- Ground floor space off of main lobby
- Beautifully built out space with large windows which provide good natural light.



Aerial



Aerial

