



FOR LEASE

North Eugene Office Space

3500 Chad Drive
Eugene OR 97408

GUARD PUBLISHING BUILDING

- North Eugene, Chad Drive location provides easy access to both Eugene & Springfield as well as I-5 and Randy Papé Beltline
- Excellent on-site parking
- Tenant Improvement Allowance Negotiable
- Access to small fitness facility for a small annual fee
- \$2.00 per rentable square foot per month, fully serviced excluding janitorial

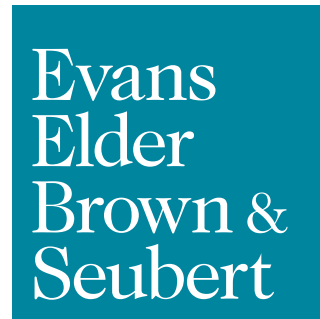

COMMERCIAL REAL ESTATE

CONTACT

Stephanie Seubert
Stephanie@eebcre.com

(541) 345-4860

Licensed in the State of Oregon.

Suite 150 Floor Plan

Guard Publishing Building
3500 Chad Drive, Eugene, Oregon 97408

Evans
Elder
Brown &
Seubert

COMMERCIAL REAL ESTATE

CONTACT

**Stephanie
Seubert**

stephanie@eebcre.com

(541) 345-4860

101 East Broadway
Suite #101
Eugene, OR 97401

Licensed in the
State of Oregon.

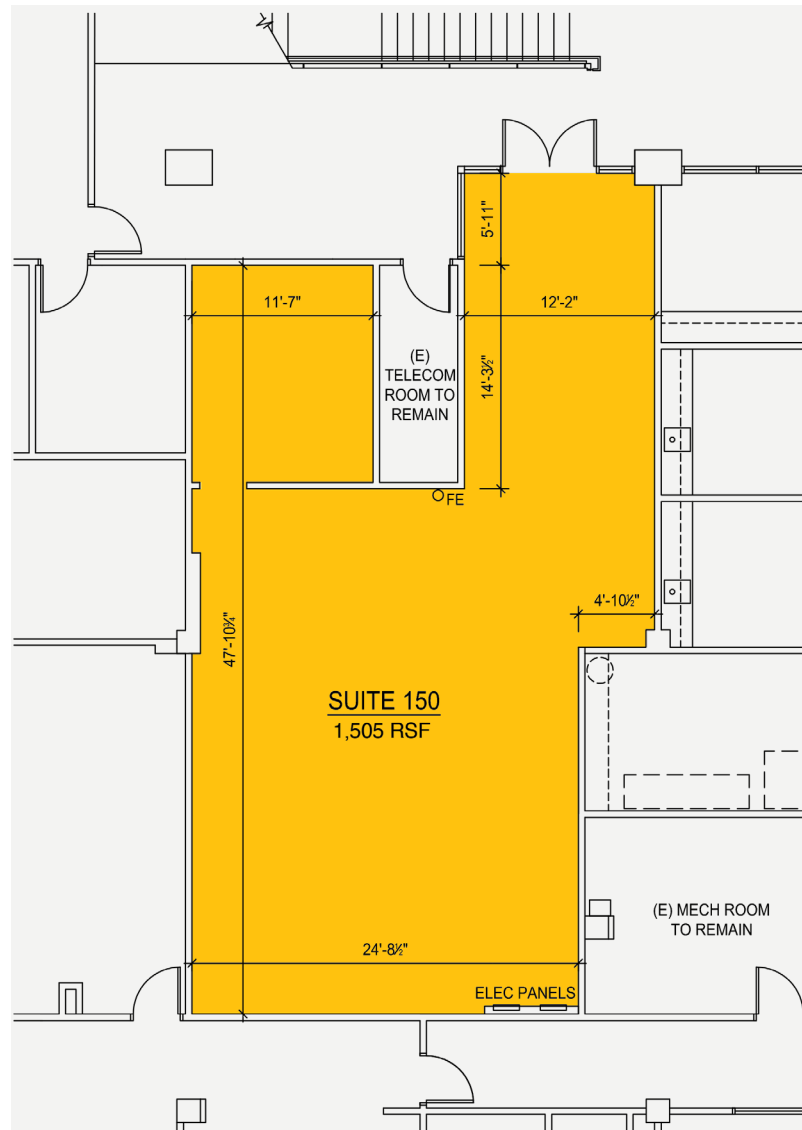

Suite 150

1,505 SQUARE FEET

- Interior Suite with glass storefront entry
- Large Open Area
- One Private Office or Data or Storage Room
- Common area restrooms
- **\$2.00 per rentable sq. ft. per month, fully serviced excluding janitorial**

South Eugene Location

Guard Publishing Building
3500 Chad Drive, Eugene, Oregon 97408



3500 CHAD DR

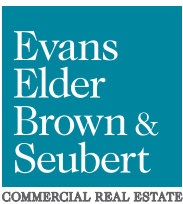

CONTACT

Stephanie Seubert
stephanie@eebcre.com

(541) 345-4860