



FOR LEASE

Medical Offices

1125 Darlene Lane
Eugene OR 97401

TWO SUITES AVAILABLE

- 2,340 square feet and 5,150 square feet on Ground Floor - can be combined
- Multiple Exam Rooms
- On-site Parking
- Adjacent to Surgery Center with use by separate agreement
- Fiber data cable available
- \$26.00 per rentable square foot annually, triple net

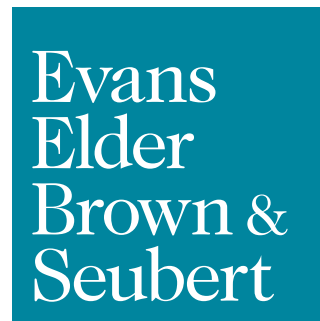

COMMERCIAL REAL ESTATE

CONTACT

Jeff Elder
jeff@eebcre.com

Ashley Hope Elder
ashley@eebcre.com

(541) 345-4860

Licensed in the State of Oregon.

Building

1125 Darlene Lane
Eugene OR 97401

Evans
Elder
Brown &
Seubert

COMMERCIAL REAL ESTATE

CONTACT

**Jeff
Elder**

jeff@eebcre.com

**Ashley
Hope
Elder**

ashley@eebcre.com

(541) 345-4860

101 East Broadway
Suite #101
Eugene, OR 97401

Licensed in the
State of Oregon.

Description

High-profile medical building located north of Valley River Center and adjacent to high-end residential areas. Excellent access from North Delta Highway at Goodpasture Island Road. Adjacent surgery center available for use by separate agreement.



Photographs

1125 Darlene Lane
Eugene OR 97401

Evans
Elder
Brown &
Seubert

COMMERCIAL REAL ESTATE

CONTACT

Jeff
Elder

jeff@eebcre.com

Ashley
Hope
Elder

ashley@eebcre.com

(541) 345-4860

101 East Broadway
Suite #101
Eugene, OR 97401

Licensed in the
State of Oregon.



Triple Nets

CURRENTLY \$12.96 PER SF

- Common Area Maintenance
- Utilities
- Real Property Taxes
- Building Insurance

Floor Plan

1125 Darlene Lane
Eugene OR 97401

Evans
Elder
Brown &
Seubert

COMMERCIAL REAL ESTATE

CONTACT

Jeff
Elder

jeff@eebcre.com

Ashley
Hope
Elder

ashley@eebcre.com

(541) 345-4860

101 East Broadway
Suite #101
Eugene, OR 97401

Licensed in the
State of Oregon.

Suite 100

5,150 SQUARE FEET

- Large Reception Area
- Eight (8) Exam Rooms
- Eight (8) Offices
- Four (4) Restrooms
- Breakroom

Suite 110

2,340 SQUARE FEET

- Four (4) Exam Rooms
- Three (3) Offices
- Two (2) Restrooms

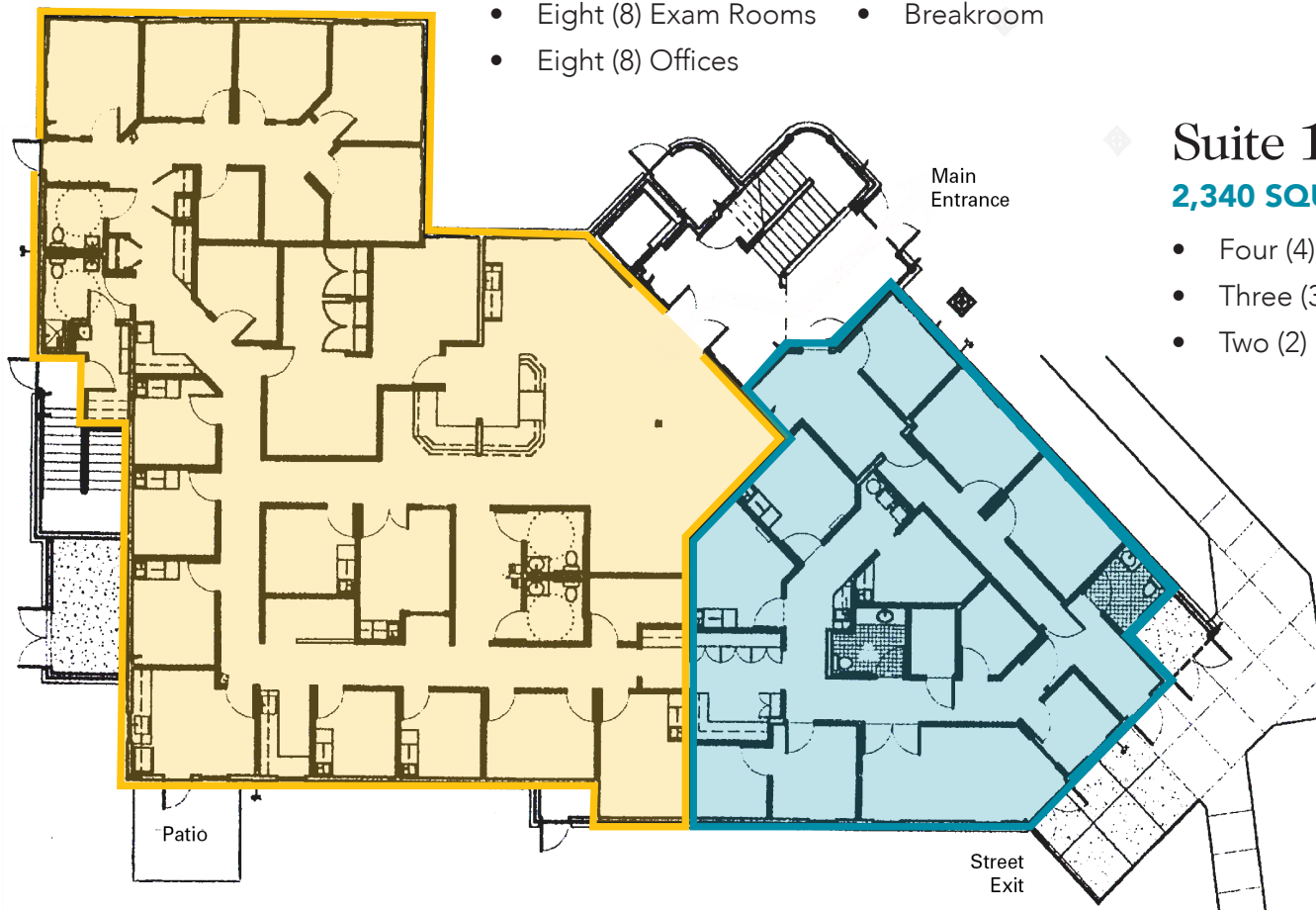

Location

1125 Darlene Lane
Eugene OR 97401

Evans
Elder
Brown &
Seubert

COMMERCIAL REAL ESTATE

CONTACT

**Jeff
Elder**

jeff@eebcre.com

**Ashley
Hope
Elder**

ashley@eebcre.com

(541) 345-4860

101 East Broadway
Suite #101
Eugene, OR 97401

Licensed in the
State of Oregon.

