



**FOR LEASE**

# Chambers Media Center

2975 Chad Drive  
Eugene, OR 97408

**APPROXIMATELY 19,907 RSF | AVAILABLE MARCH 1ST**

- Ground floor office/call center space
- Conveniently located with excellent access to I-5 and Randy Papé Beltline Highway
- Previously occupied by a call center with 165+ workstations
- \$1.00 per square foot per month, NNN  
(NNN's approximately 74¢ per square foot per month)

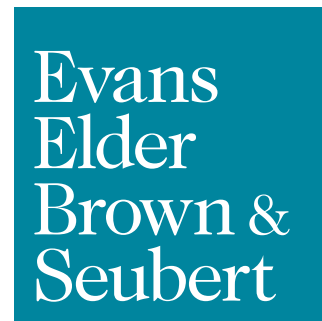

COMMERCIAL REAL ESTATE

## CONTACT

**Stephanie Seubert**

stephanie@eebcre.com

**(541) 345-4860**

Licensed in the State of Oregon.

# Ground Floor Plan

2975 Chad Drive  
Eugene, Oregon 97408

Evans  
Elder  
Brown &  
Seubert

COMMERCIAL REAL ESTATE

## CONTACT

**Stephanie  
Seubert**

stephanie@eebcre.com

**(541) 345-4860**

101 East Broadway  
Suite #101  
Eugene, OR 97401

Licensed in the  
State of Oregon.

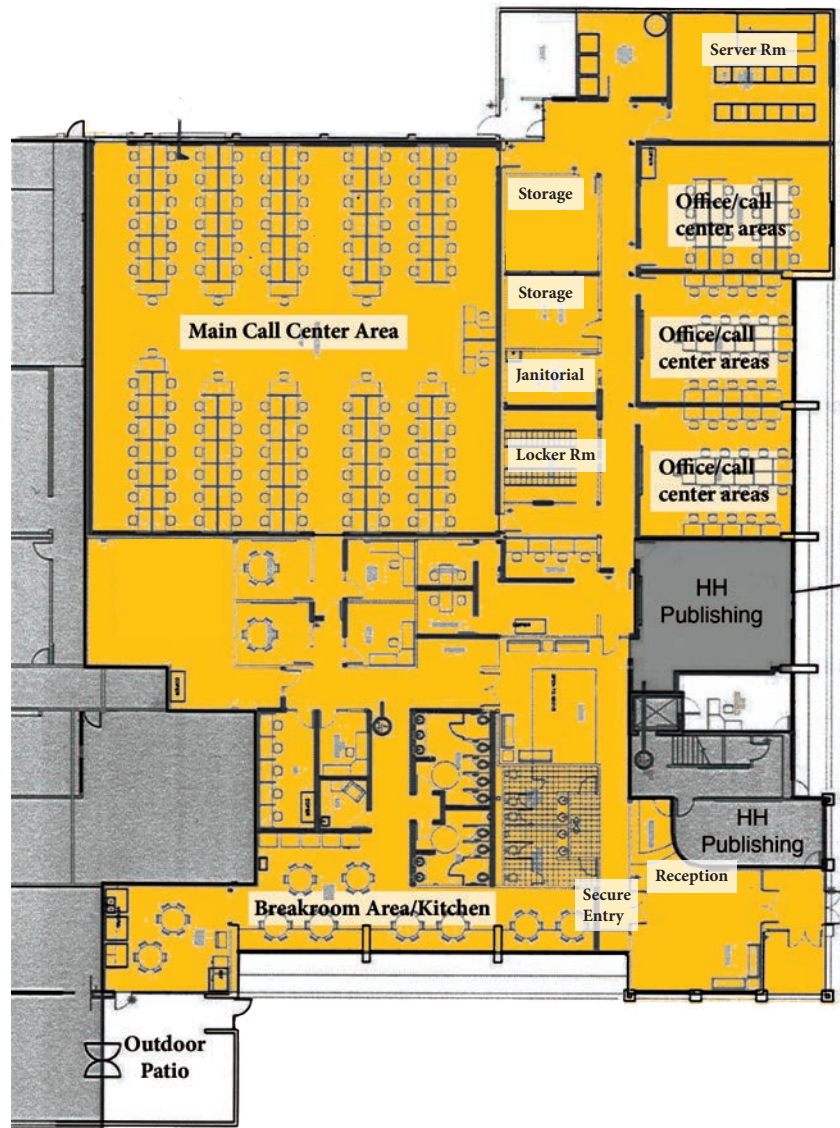

## Single Level, Ground Floor Office Space

### AMENITIES INCLUDE:

- Large open area with sound proofing to allow for a call center with over 125 workstations
- Three additional large training/call center rooms
- Call center furnishings may be available for use by new tenant
- Large server room
- Large break area with outdoor patio
- Large multi-stall restrooms
- Large secure lobby/reception area
- Multiple small conference rooms/additional offices
- Employee area with lockers
- Janitorial room
- Storage areas
- Good on-site parking
- Convenient North Eugene location with access to public transportation



# Photographs

2975 Chad Drive  
Eugene, Oregon 97408

Evans  
Elder  
Brown &  
Seubert

COMMERCIAL REAL ESTATE

## CONTACT

**Stephanie  
Seubert**

stephanie@eebcre.com

**(541) 345-4860**

101 East Broadway  
Suite #101  
Eugene, OR 97401

Licensed in the  
State of Oregon.





# Location

2975 Chad Drive  
Eugene, Oregon 97408

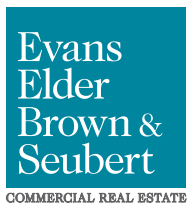

## CONTACT

**Stephanie Seubert**

stephanie@eebcre.com

**(541) 345-4860**